

Deck or Loft Railing Order Guidelines

Dundalk Enterprises Inc. designs your railing free of charge if you supply us with all measurements neat and clear. Simply follow the steps below and we will process a quote for you.

- 1) Draw a bird's eye view of your deck, loft and stairs. (Below is an example drawing)
 - a. Specify existing posts and where we need to supply posts
 - b. Measurements in between existing posts
 - c. Drawing does not have to be to scale
 - d. Corner to corner measurements if we supply posts
 - e. If corner angles are different then 90 degrees please specify the angle in degrees
 - f. Specify if you need posts at end walls
 - g. Please provide measurements in inches/feet

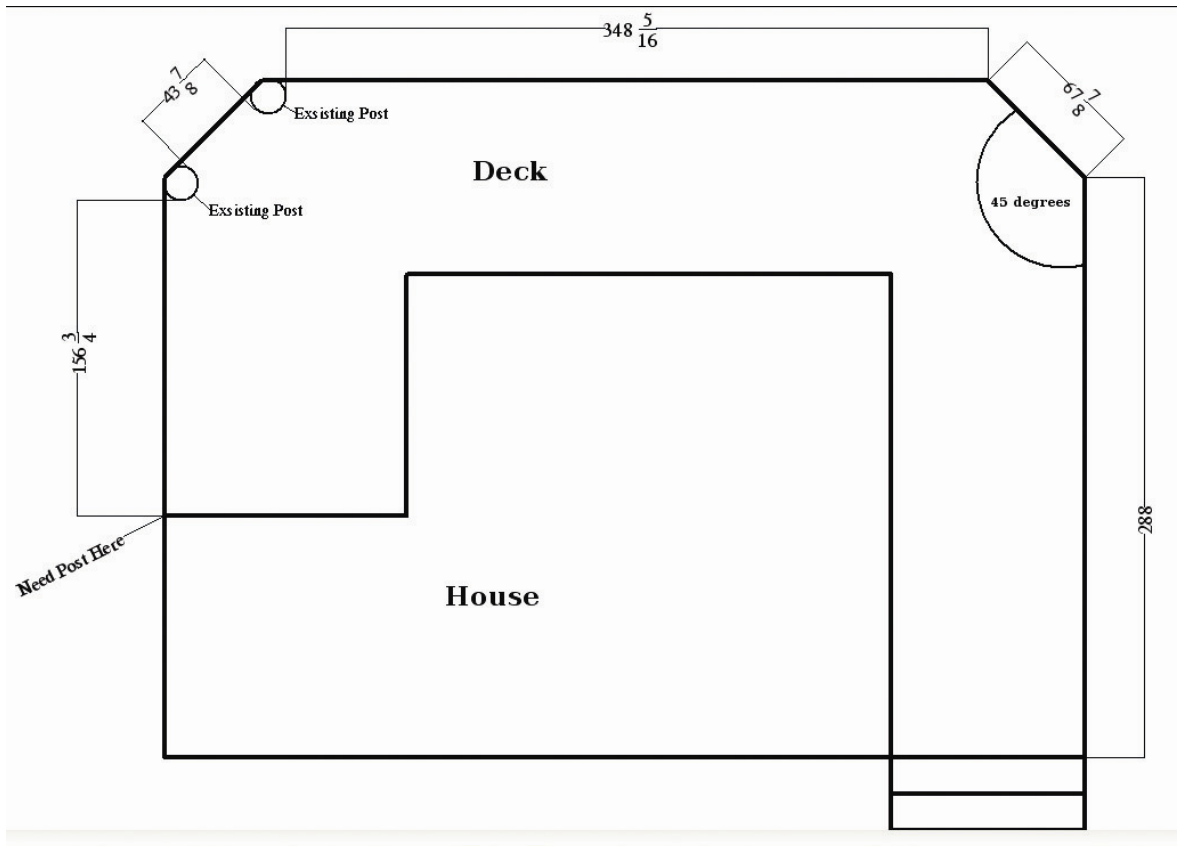

- 2) Specify locations of Classic Railings and Silhouette Inserts as well as height of Railing. (36" or 42" available)
- 3) Specify 5" or 6" diameter posts and square shoulder tenons or 8" deck notch.
- 4) Use Separate Pages for Steps and verify locations on original drawings (see step order guidelines page)
- 5) We supply railing and posts pre-assembled and numbered for easy installation.
- 6) Mail or fax your drawings to Dundalk Enterprises Inc. with your contact information and we will return a final quote to you.

Dundalk Enterprises Inc. 318497 8th Line Dundalk, Ontario N0C 1B0

Phone(519) 923-9813 Fax: (519) 923-9910 Email: info@dundalkenterprises.ca Website: www.shedsandpatio.com